

Acme Pumps

SES Process Pumps

For Petrochemical, Chemical & All Other Industries



Centre-line supported • 25 bar working pressure • Back-pull-out construction

Description

Acme type SES centre-line supported centrifugal pumps are of single-stage end suction design. They are specially developed for the process industries incorporating the latest CFX technique and precision casting technology. Available in cast steel, stainless steel and other corrosion-resistant materials, they are ideal for petrochemical, chemical and all other process industries.

Standard Features

- **25 bar working pressure** as standard requires robust and solid construction to ensure durability even under high suction pressure condition.
- **More than 3 mm corrosion allowance** for extended use on corrosive applications.
- **Back-pull-out construction** allows rotating assembly to be withdrawn without disturbing the suction and delivery connections.
- **Double volute design** available for selected pumps. It eliminates radial load by balancing the hydraulic force of the liquid within the pump casing, extends seal and bearing life and minimizes vibration and noise.
- **Oil lubricated heavy-duty bearings** with minimum 50,000 hours operating life under normal conditions.
- **Heavy-duty, stiff solid shaft design** with low L3/D4 ratio ensures less than 0.05 mm shaft deflection at the seal face under all operating conditions. This extends the seal life.
- **Seal housing** is constructed to accommodate different seal designs, so as to meet the severe heavy-duty requirements.
- **Excellent parts interchangeability** reduces inventory level for spare parts to a minimum.
- **Labyrinth seal** is fitted as standard to seal out water and other harmful contaminants.

Optional Features

Stuffing box cooling is available to meet high temperature service requirements.

Bearing housing cooling is available for pumping liquids above 110 °C.

Construction

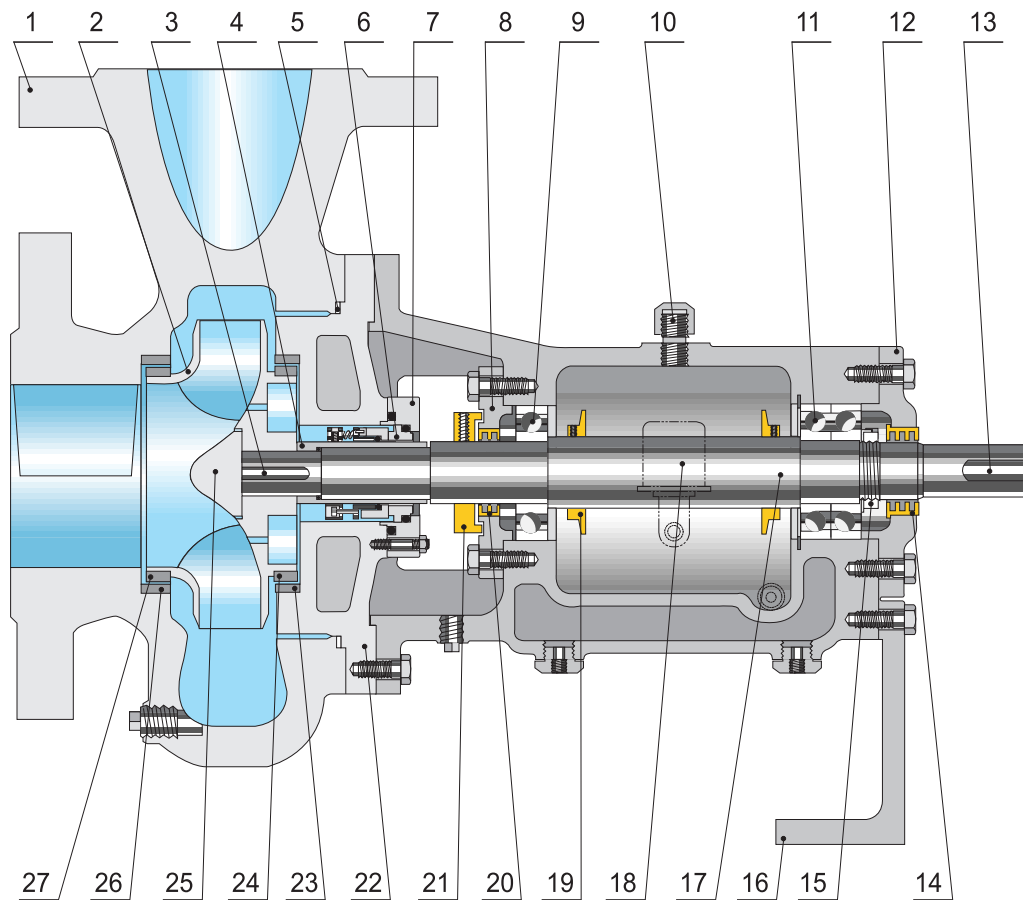

- | | | |
|----------------------|------------------------------|------------------------|
| 1 Pump Casing | 10 Breath Valve | 19 Flinger |
| 2 Impeller | 11 Double Row Thrust Bearing | 20 Labyrinth Seal |
| 3 Impeller Key | 12 Thrust Bearing Cover | 21 Deflector |
| 4 Shaft Sleeve | 13 Coupling Key | 22 Stuffing Box Cover |
| 5 Casing Joint | 14 Labyrinth Seal | 23 Back Casing Ring |
| 6 Mechanical Seal | 15 Bearing Lock Nut | 24 Back Impeller Ring |
| 7 Seal Gland | 16 Bearing Bracket Foot | 25 Impeller Nut |
| 8 Line Bearing Cover | 17 Shaft | 26 Front Casing Ring |
| 9 Line Bearing | 18 Constant Level Oiler | 27 Front Impeller Ring |

Material Specifications

Material Class	Carbon Steel	CS/11-13% Cr.	11-13% Cr.	316 SS
Casing	Carbon Steel	Carbon Steel	11-13% Cr.	316 SS
Stuffing Box Cover	Carbon Steel	Carbon Steel	11-13% Cr.	316 SS
Impeller	Carbon Steel	11-13% Cr.	11-13% Cr.	316 SS
Casing Wear Ring	11-13% Cr. Hardened	11-13% Cr. Hardened	11-13% Cr. Hardened	316 SS(Hard-faced)
Impeller Wear Ring	11-13% Cr. Hardened	11-13% Cr. Hardened	11-13% Cr. Hardened	316 SS(Hard-faced)
Shaft	Cr. - Mo Steel	Cr. - Mo Steel	11-13% Cr.	316 SS or Duplex
Shaft Sleeve	304 S.S.	304 S.S.	304 S.S.	316 SS

Operating Limits

	Working Pressure	Test Pressure	Max.Liquid Temperature
Standard	25 bar	37.5 bar	110°C without cooling
Option	40 bar	60 bar	400°C with cooling

Coverage charts-50Hz

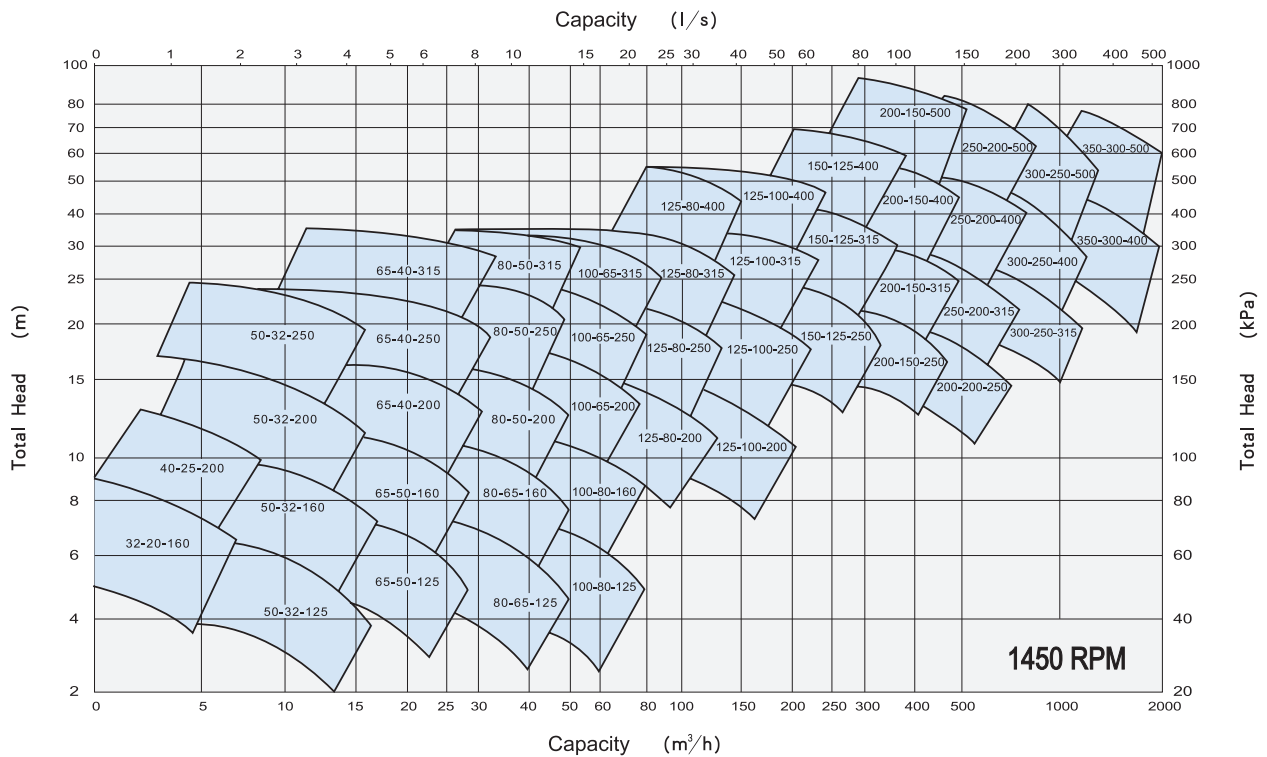
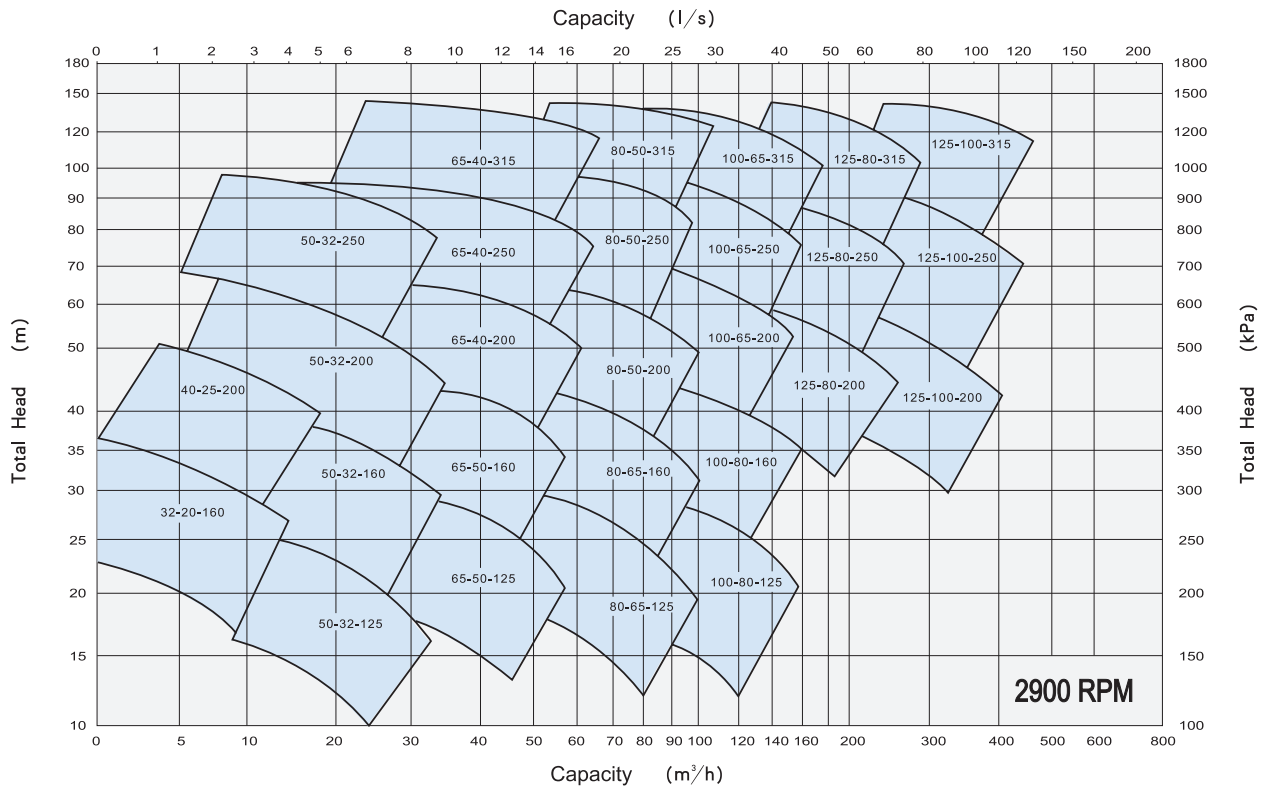

Acme Pumps Inc,
 Denville, New Jersey 07834,
 U.S.A.
 Tel: (973) 3359686
 Fax: (973) 3359624

Distributor: